



产品手册

PRODUCT MANUAL



四川森普管材股份有限公司
Sichuan Senpu Pipe Co., Ltd.
地址/ADD:四川德阳高新技术产业园区
Deyang New&High-Tech. Industry Zone
电话/Tel:0838-2801958 2801862
传真/Fax:0838-2852825
邮编/Post:618000
E-Mail:senpu@senpu.com
Http:www.senpu.com

天津森普管材有限公司
Tianjin Senpu Pipe Co., Ltd.
地址/Add:天津市大港区安达工业园
Anda Industrial Park,Dagang District,Tianjin City
电话/Tel:022-63312585
传真/Fax:022-63312558
邮编/Post:300270
Http:www.senpu.com

四川森普进出口贸易有限责任公司
Sichuan Senpu Import & Export Trade Co., Ltd.
地址/ADD:四川德阳高新技术产业园区
Deyang New&High-Tech. Industry Zone
电话/Tel:0838-2852695
传真/Fax:0838-2808183
邮编/Post:618000
Http:www.senpu.com

四川森普建筑工程有限公司
Tianjin Senpu Construction Engineering Co., Ltd.
地址/ADD:四川德阳高新技术产业园区
Deyang New&High-Tech. Industry Zone
电话/Tel:0838-2802597
传真/Fax:0838-2802597
邮编/Post:618000
Http:www.senpu.com

四川森普管材股份有限公司
SICHUAN SENPU PIPE CO.,LTD.

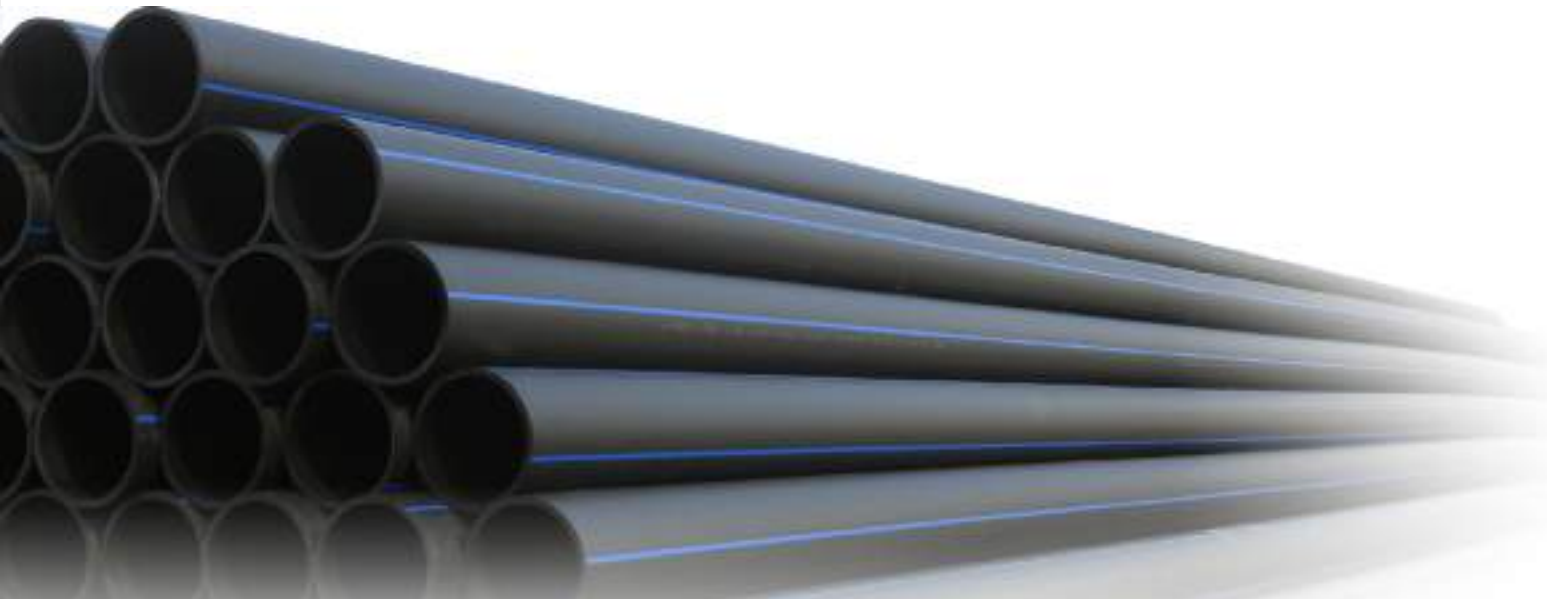

森普管材 品质第一

SENPU PIPE QUALITY FIRST

SENPU PIPE

给水用聚乙烯 (PE) 管材

Polyethylene(PE) pipes for water supply

“森普”牌给水用聚乙烯管材采用优质PE80或PE100原料制造，达到或超过GB/T13663《给水用聚乙烯(PE)管材》标准要求，具有优良的物理力学性能。管材为蓝色或黑色带纵向蓝色共挤色条。执行标准：GB/T13663-2000、ISO4427-2:2007

- 性能特点：
- 管材按50年使用寿命设计；
 - 抗冲击性能优异，耐低温性能好，低温脆化温度可达-70℃；
 - 化学稳定性好，耐各种酸、碱、盐腐蚀；
 - 韧性好、耐扭曲、抗地震等；
 - 卫生性好，解决了饮用水二次污染问题，符合GB/T17219卫生安全性评价规定；
 - 重量轻、搬运方便；
 - 施工方便、焊接工艺简单、工程综合造价低；
 - 管道采用热熔连接，性能可靠，管网漏损率低。
- 用途：

适用于输送温度不高于40℃的液体介质（一般埋地或隐蔽安装），主要用于市政供水、建筑给水、化工、医药、造纸、农灌等领域，同时也可采用插入法或衬装法更新旧管网，实现不开挖或少开挖，进行旧网改造。

“Senpu” Polyethylene(PE) pipes for water supply is made from PE80/PE100 raw material, the pipe has excellent physical and mechanical properties, the pipe reached or exceed standard GB/T13663《Polyethylene pipes for water supply》. The color of pipe is blue or black with blue strip. Standard: GB/T13663-2000、ISO4427-2:2007

- Features:
1. The design life of pipe is 50 years;
 2. Excellent impact performance, good low temperature impact resistance: low temperature brittleness of -70℃;
 3. Good chemical stability, resistance to acid, alkali, salt corrosion;
 4. Toughness, resistance to distortion and anti-earthquake;
 5. Sanitary, It solves the secondary pollution of water supply and reached the requirement of standard GB/T17219;
 6. Light weight and easy handing;
 7. Simple and convenient construction, simple welding technique, engineering and lower total cost;
 8. Using hot melt connection, reliable and no leakage;

Application:
The pipe applicable to supply liquid medium with temperature no higher than 40℃ (buried or concealed installation), and mainly used for municipal water supply, building water supply, chemical, medicine, papermaking and agricultural irrigation, and may be used for trenchless old pipe website transformation with the insertion or liner installation method.



执行标准/Standard: GB/T13663-2000

给水用聚乙烯 (PE80) 管材

公称外径 Nominal outside diameter d _n (mm)	公称壁厚 Nominal wall thickness e _n (mm)				
	PN0.4	PN0.6	PN0.8	PN1.0	PN1.25
	SDR33	SDR21	SDR17	SDR13.6	SDR11
20	-	-	-	-	2.3
25	-	-	-	2.3	2.3
32	-	-	2.3	2.4	3.0
40	-	-	2.4	3.0	3.7
50	-	2.4	3.0	3.7	4.6
63	2.4	3.0	3.8	4.7	5.8
75	2.6	3.6	4.5	5.6	6.8
90	2.8	4.3	5.4	6.7	8.2
110	3.4	5.3	6.6	8.1	10.0
125	3.8	6.0	7.4	9.2	11.4
140	4.3	6.7	8.3	10.3	12.7
160	4.9	7.7	9.5	11.8	14.6
180	5.5	8.6	10.7	13.3	16.4
200	6.2	9.6	11.9	14.7	18.2
225	6.9	10.8	13.4	16.6	20.5
250	7.7	11.9	14.8	18.4	22.7
280	8.6	13.4	16.6	20.6	25.4
315	9.7	15.0	18.7	23.2	28.6
355	10.9	16.9	21.1	26.1	32.2
400	12.3	19.1	23.7	29.4	36.3
450	13.8	21.5	26.7	33.1	40.9
500	15.3	23.9	29.7	36.8	45.4
560	17.2	26.7	33.2	41.2	50.8
630	19.3	30.0	37.4	46.3	57.2
710	21.8	33.9	42.1	52.2	64.5
800	24.5	38.1	47.4	58.8	72.6
900	27.6	42.9	53.3	66.2	81.7
1000	30.6	47.7	59.3	72.5	90.2
1200	36.7	57.2	67.9	88.2	-

给水用聚乙烯 (PE100) 管材

公称壁厚 Nominal wall thickness e _n (mm)				
PN0.6	PN0.8	PN1.0	PN1.25	PN1.6
SDR26	SDR21	SDR17	SDR13.6	SDR11
-	-	-	2.3	2.3
-	-	-	2.3	2.3
-	-	2.3	2.4	3.0
-	2.3	2.4	3.0	3.7
2.3	2.4	3.0	3.7	4.6
2.4	3.0	3.8	4.7	5.8
2.9	3.6	4.5	5.6	6.8
3.5	4.3	5.4	6.7	8.2
4.2	5.3	6.6	8.1	10.0
4.8	6.0	7.4	9.2	11.4
5.4	6.7	8.3	10.3	12.7
6.2	7.7	9.5	11.8	14.6
6.9	8.6	10.7	13.3	16.4
7.7	9.6	11.9	14.7	18.2
8.6	10.8	13.4	16.6	20.5
9.6	11.9	14.8	18.4	22.7
10.7	13.4	16.6	20.6	25.4
12.1	15.0	18.7	23.2	28.6
13.6	16.9	21.1	26.1	32.2
15.3	19.1	23.7	29.4	36.3
17.2	21.5	26.7	33.1	40.9
19.1	23.9	29.7	36.8	45.4
21.4	26.7	33.2	41.2	50.8
24.1	30.0	37.4	46.3	57.2
27.2	33.9	42.1	52.2	64.5
30.6	38.1	47.4	58.8	72.6
34.4	42.9	53.3	66.2	81.7
38.2	47.7	59.3	72.5	90.2
45.9	57.2	67.9	88.2	-

注：斜体加粗规格执行企业标准。NOTE:Italics emboldening specifications executive enterprise standards



森普管材 品质第一

SENPU PIPE QUALITY FIRST

SENPU PIPE

燃气用埋地聚乙烯 (PE) 管材

Buried polyethylene(PE)pipe for the supply of gaseous fuels

“森普”牌燃气用埋地聚乙烯管材采用优质PE80或PE100原料制造，达到或超过GB15558.1-2015《燃气用埋地聚乙烯 (PE) 管道系统第1部分：管材》标准要求，具有优良的物理力学性能。管材为黑色 (PE80/PE100)、黄色 (PE80)、橙色 (PE100)，其中PE80黑色管纵向带黄色色条，PE100黑色管纵向带橙色色条。

执行标准：GB15558.1-2015《燃气用埋地聚乙烯 (PE) 管道系统第1部分：管材》

性能特点：

- 管材按50年使用寿命设计；
- 抗冲击性能优异，耐低温性能好，低温脆化温度可达-70℃；
- 化学稳定性好，耐各种酸、碱、盐腐蚀；
- 韧性好、耐扭曲、抗地震、良好的耐环境应力开裂性能等，优异的耐慢速裂纹扩展和抵抗快速开裂能力；
- 重量轻、搬运方便；
- 施工方便、焊接工艺简单、工程综合造价低；
- 管道采用热熔连接，性能可靠，管网漏损率低。

“Senpu” Buried polyethylene(PE)pipe for the supply of gaseous fuels is made from PE80/PE100 raw material, The pipe reached or exceed the gas buried PE GB15558.1-2015 "(PE) piping systems part first: requirements" standard material, It has excellent physical and mechanical properties. The pipe is black (PE80/PE100), yellow (PE80), orange (PE100), which PE80 black with yellow color trip PE100, black pipe is with orange color strip.

Implementation standard: GB15558.1-2015 "first part of gas buried polyethylene (PE) pipe system for gas use: pipe"

Performance characteristics:

- life design of the pipe used by 50 years;
- excellent impact resistance, good low temperature resistance, low temperature embrittlement temperature is -70 DEG c;
- good chemical stability, resistance to acid, alkali and salt corrosion;
- High - toughness, distortion resistance, earthquake resistance, good stress cracking resistance, excellent resistance to slow crack growth resistance and fast cracking ability;
- Light weight, convenient transportation;
- In the welding process is simple, convenient construction, low cost of project;
- In the pipeline using hot melt connection, reliable



众木成森 普被天下 **SENPU PIPE**
PRODUCT MANUAL



执行标准/Standard:GB15558.1- 2015

燃气用埋地聚乙烯 (PE) 管

公称外径 Nominal outer diameter dn(mm)	公称壁厚 Nominal wall thickness en(mm)							
	PE80				PE100			
	SDR26	SDR21	SDR17	SDR11	SDR26	SDR21	SDR17	SDR11
20	-	-	-	3.0	-	-	-	3.0
25	-	-	-	3.0	-	-	-	3.0
32	-	-	3.0	3.0	-	-	3.0	3.0
40	-	-	3.0	3.7	-	-	3.0	3.7
50	-	3.0	3.0	4.6	-	3.0	3.0	4.6
63	-	3.0	3.8	5.8	-	3.0	3.8	5.8
75	3.0	3.6	4.5	6.8	3.0	3.6	4.5	6.8
90	3.5	4.3	5.4	8.2	3.5	4.3	5.4	8.2
110	4.2	5.3	6.6	10.0	4.2	5.3	6.6	10.0
125	4.8	6.0	7.4	11.4	4.8	6.0	7.4	11.4
140	5.4	6.7	8.3	12.7	5.4	6.7	8.3	12.7
160	6.2	7.7	9.5	14.6	6.2	7.7	9.5	14.6
180	6.9	8.6	10.7	16.4	6.9	8.6	10.7	16.4
200	7.7	9.6	11.9	18.2	7.7	9.6	11.9	18.2
225	8.6	10.8	13.4	20.5	8.6	10.8	13.4	20.5
250	9.6	11.9	14.8	22.7	9.6	11.9	14.8	22.7
280	10.7	13.4	16.6	25.4	10.7	13.4	16.6	25.4
315	12.1	15.0	18.7	28.6	12.1	15.0	18.7	28.6
355	13.6	16.9	21.1	32.2	13.6	16.9	21.1	32.2
400	15.3	19.1	23.7	36.4	15.3	19.1	23.7	36.4
450	17.2	21.5	26.7	40.9	17.2	21.5	26.7	40.9
500	19.1	23.9	29.7	45.5	19.1	23.9	29.7	45.5
560	21.4	26.7	33.2	50.9	21.4	26.7	33.2	50.9
630	24.1	30.0	37.4	57.3	24.1	30.0	37.4	57.3

埋地排水用波纹管

Corrugated pipes for underground sewer

“森普”牌埋地排水用双壁波纹管采用优质材料生产，是一种新型环保塑料管材，具有重量轻、环刚度高，施工方便，其综合造价低于铸铁管和混凝土管道等特点。本公司可提供两种类型的双壁波纹管：聚乙烯（HDPE）双壁波纹管；钢带增强聚乙烯（PE）螺旋波纹管。

执行标准：

GB/T19472.1《埋地用聚乙烯（PE）结构壁管道系统第1部分：聚乙烯双壁波纹管材》

CJ/T225《埋地排水用钢带增强聚乙烯（PE）螺旋波纹管》

性能特点：

- 重量轻，环刚度高；
- 施工方便，工期短，综合造价低；
- 内壁光滑，流量大；
- 耐腐蚀，不结垢基本不用疏通；
- 柔性接头，抗不均匀沉降能力强，不易泄露。

用途：

市政工程：用于市政地下排水、排污、雨水收集、输水、通风等。

电气电信工程：作为低压电力电缆、光缆、通讯信号电缆的保护管。

工业：由于聚乙烯材料具有优良的耐酸、碱及耐腐蚀能力，双壁波纹管广泛用于农田、果园、茶园以及林带热点排灌，亦可用于农村改水、灌溉用非压力等。

道路公用工程：用作铁路、高速公路、高尔夫球、足球场等的渗、排水管。

“Senpu” Corrugated pipes for underground sewer is made from high quality raw materials, it is a new kind of environmental protection plastic pipe, and has the characteristics of light weight, high ring stiffness, easy installation, lower integrated project costs than cast iron pipe and concrete pipe. Senpu company can provide two types of double wall corrugated pipe: Polyethylene(PE) double wall corrugated pipe; Metal reinforced polyethylene(PE) spiral corrugated pipe.

Product Standard:

GB/T19472.1《Polyethylene structure wall pipeline system for underground usage Part 1:Polyethylene double wall corrugated pipes》

CJ/T225《Metal reinforced polyethylene (PE) spiral corrugated pipe for underground sewer》

Features:

1. Light weight, high ring stiffness;
2. easy installation, short construction period, low integrated project costs;
3. Smooth inner wall, large flow ;
4. Excellent corrosion resistance performance, resistance to scaling;
5. Flexible connection, strong resistance to uneven settlement, not easy to leak.

Applications:

Municipal engineering: It used for municipal underground drainage, sewerage, rainwater collecting, water delivery and ventilation, etc.

Electrical telecommunication engineering: can be used as protective pipes of the power cables, optical cables, and communication signal cables.

Industrial areas: Due to the polyethylene and polypropylene's advantages of excellent resistance to acid, alkali and corrosion resistance, the double-wall corrugated pipes are widely used in farmland, orchards, tea plantations and forest heat irrigation, as well as rural water supply and irrigation.

Road public projects: It used as infiltration and drainage pipes in railways, highways, golf courses, and football fields.



SENPU PIPE

执行标准/Standard:GB/T19472.1

聚乙烯（PE）双壁波纹管材

公称内径 Nominal inside diameter DN/ID(mm)	环刚度 Ring Stiffness (kN/m ²)	
	SN4	SN8
200	SN≥4	SN≥8
300	SN≥4	SN≥8
400	SN≥4	SN≥8
500	SN≥4	SN≥8

执行标准/Standard:CJ/T225-2011

钢带增强聚乙烯(PE)螺旋波纹管

公称内径 Nominal inside diameter DN/ID(mm)	环刚度 Ring Stiffness (kN/m ²)		
	SN8	SN12.5	SN16
600	≥8	≥12.5	≥16
700	≥8	≥12.5	≥16
800	≥8	≥12.5	≥16
900	≥8	≥12.5	≥16
1000	≥8	≥12.5	≥16
1100	≥8	≥12.5	≥16
1200	≥8	≥12.5	≥16
1300	≥8	≥12.5	≥16
1400	≥8	≥12.5	≥16
1500	≥8	≥12.5	≥16
1600	≥8	≥12.5	≥16
1800	≥8	≥12.5	≥16

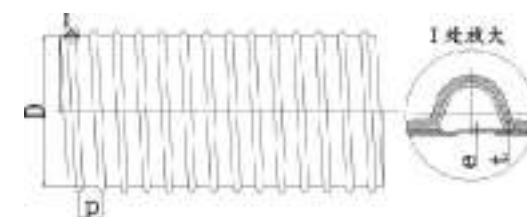
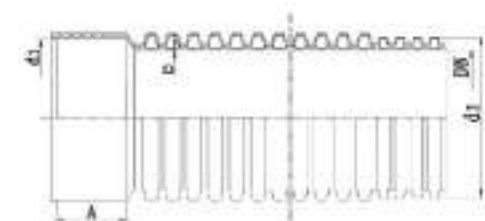



森普管材 品质第一
SENPU PIPE QUALITY FIRST

SENPU PIPE

建筑用无规共聚聚丙烯 (PP-R) 冷热水管
PP-R pipes for hot and cold water installation

“森普”牌冷热水用无规共聚聚丙烯 (PP-R) 管材使用优质的PPR专用原料生产, 达到或超过GB/T18742.2《冷热水用聚丙烯管道系统第2部分: 管材》标准要求, 具有优良的物理力学性能。管材为灰色带纵向蓝色或橘红色共挤色条。

执行标准: GB/T18742.2-2002

性能特点:

- 重量轻、良好的卫生性能、耐腐蚀、不结垢;
- 保温节能; 良好的耐高温性能;
- 卫生性好, 解决了饮用水二次污染问题, 符合GB/T17219-1998卫生安全性评价规定;
- 使用寿命长, 可用于热水供应, 适当压力下70℃长期使用可达50年;
- 安装方便、可用热熔承插连接, 接头性能可靠。

用途: 主要用于冷热水输送 (长期使用温度不高于70℃, 故障温度可高达95℃)、民用建筑取暖及空调设备系统, 也可用在工业建筑、纯净水、医药、化工、农业和其他输送液态介质的场所。

“Senpu” PP-R pipes for hot and cold water installation is made from PE80/PE100 raw material, the pipe has excellent physical and mechanical properties, the pipe reached or exceed standard GB/T18742.2《Polypropylene piping systems for hot and cold water installation-Part 2:Pipes》.The colors of pipe is grey with blue or orange strips.

Standard: GB/T18742.2-2002

Product Features:

1. Light weight, good hygienic properties, resistance to corrosion, not scaling;
2. Heat preservation and energy saving ,high temperature resistance;
- 3.Health,can solve the secondary pollution of drinking water, and in accordance with GB/T17219 standard;
- 4.Long service life. The pipe can be used for hot water supply ,the pipes' use life can reach 50 years,under the conditions of working temperature 70℃ and appropriate pressure,;
5. Easy installation ,hot met connection is most useful and the connection is reliable.

Applications: It mainly used for hot and cold water supply (the long-term normal delivery of water temperature is 70 ℃, short-term use of high temperature can be up to 95 ℃),civil building heating and air conditioning systems, it is also can be used for industrial buildings, purified water, medicine, chemical industry, agriculture and other place for conveying liquid medium.

执行标准/Standard:GB/T18742.2-2002

公称外径 Nominal outside diameter d _n (mm)	公称壁厚 Nominal wall thickness e _n (mm)				
	S5	S4	S3.2	S2.5	S2
20	2.0	2.3	2.8	3.4	4.1
25	2.3	2.8	3.5	4.2	5.1
32	2.9	3.6	4.4	5.4	6.5
40	3.7	4.5	5.5	6.7	8.1
50	4.6	5.6	6.9	8.3	10.1
63	5.8	7.1	8.6	10.5	12.7
75	6.8	8.4	10.3	12.5	15.1
90	8.2	10.1	12.3	15.0	18.1
110	10.0	12.3	15.1	18.3	22.1
125	11.4	14.0	17.1	20.8	25.1
140	12.7	15.7	19.2	23.3	28.1
160	14.6	17.9	21.9	26.6	32.1

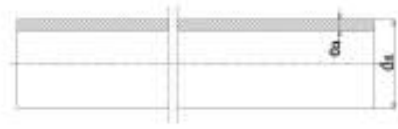

众木成森 普被天下 **SENPU PIPE**
PRODUCT MANUAL

耐热聚乙烯管材
Heat-resistant polyethylene pipe

“森普”牌耐热聚乙烯管材采用优质树脂原料生产, 是一种新型环保的可用于输送热水的塑料管材。结合了钢铁与传统塑料的优点, 具有优异的韧性、耐应力开裂、耐低温、耐冲击、长期耐液压性能耐热蠕变性能, 可应用于中大口径管材领域。

执行标准:

国家标准: GB/T 28799.2; 企业标准: Q/70895545-1.3

性能特点:

- 化学稳定性好, 具有优异的耐腐蚀性能;
- 具有优异的耐低温性;
- 柔韧性好, 具有良好的耐地势沉降性能;
- 热传导系数高, 在用作地暖管时, 可以提高热传导效率, 节约大量能源;
- 不易结垢且内壁光滑, 对水的摩擦阻力小, 输水效率高;
- 可以热熔连接, 系统密封性能优异;
- 可盘卷, 满足了地暖管不允许有接头的要求。

用途和适用范围

适用于正常工作温度不超过80℃, 故障温度不超过100℃的冷热水管道系统, 包括建筑用冷热水系统、饮用水管道系统、地面辐射采暖系统、空调用管道系统、工业用大口径冷热水输送系统等。

“Senpu” heat-resistant polyethylene pipe is made from high quality raw materials, it is a new kind of environmental protection plastic pipe ,and has the characteristics of toughness ,resistance to stress cracking, good low temperature impact resistance, excellent impact performance, long-term hydrostatic resistance and anti-heat creep. The pipe can be used in large-diameter pipe field.

National Standard: GB/T28799.2

Enterprise Standard: Q/70895545-1.3

Features:

1. Excellent chemical stability and corrosion resistance;
2. Good low temperature impact resistance;
- 3.It has the advantage of flexibility , toughness and good terrain settlement;
4. High thermal conductivity, the pipe can increase the heat transfer efficiency and save energy when be used as floor heating pipe;
- 5.Smooth inner wall, no easy scaling, small frictional resistance and high water conveyance efficiency.
- 6.Using hot melt connection, excellent sealing performance.
- 7.It can be coiled and make up for the floor heating pipes' requirement of no joints.

Applications:

It is Suitable for hot and cold water supply that the long-term normal delivery of water temperature is no more than 80 ℃ , short-term use of high temperature up to 100 ℃,including hot and cold water system, drinking water supply piping system, radiant floor heating system, air-conditioning system, industrial large-diameter hot and cold water supply system.



执行标准/Standard: GB/T 28799.2-2012

公称外径 Nominal outside diameter d _n (mm)	公称壁厚 Nominal wall thickness e _n (mm)				
	S6.3	S5	S4	S3.2	S2.5
20	—	2.0	2.3	2.8	3.4
25	2.0	2.3	2.8	3.5	4.2
32	2.4	2.9	3.6	4.4	5.4
40	3.0	3.7	4.5	5.5	6.7
50	3.7	4.6	5.6	6.9	8.3
63	4.7	5.8	7.1	8.6	10.5
75	5.6	6.8	8.4	10.3	12.5
90	6.7	8.2	10.1	12.3	15.0
110	8.1	10.0	12.3	15.1	18.3
125	9.2	11.4	14.0	17.1	20.8
140	10.3	12.7	15.7	19.2	23.3
160	11.8	14.6	17.9	21.9	26.6
180	13.3	16.4	20.1	24.6	-
200	14.7	18.2	22.4	-	-
225	16.6	20.5	-	-	-
250	18.4	22.7	-	-	-
280	20.6	25.4	-	-	-
315	23.2	28.6	-	-	-
355	26.1	32.2	-	-	-
400	29.4	36.3	-	-	-
450	33.1	40.9	-	-	-



森普管材 品质第一

SENPU PIPE QUALITY FIRST

SENPU PIPE

浆体输送用聚乙烯(PE)耐磨管道 Polyethylene conveying slurry (PE) wear-resistant pipe

“森普”牌浆体输送用聚乙烯(PE)耐磨管道采用优质的高分子量聚乙烯制造,产品性能优越,耐磨抗冲击,自润滑,耐腐蚀、耐低温、卫生无毒、不粘附、不吸水等,是一种较为理想的管材,可广泛应用于各种浆体输送管线。

性能特点:

- 1、高耐磨性:管壁光滑,摩擦系数小,耐磨性在输送各种浆体时比钢管、不锈钢管高4倍以上,输送流量比钢管大10~40%,可长期保持流速和流量不减。在原油、泥浆等输送管道方面也非常适用
- 2、抗拉强度高抗冲击性:抗环境应力开裂能力强,抗冲击性和吸收冲击性能高;
- 3、抗腐蚀性:化学稳定性好,耐各种酸、碱、盐腐蚀;
- 4、耐低温性:耐低温性能优异,其耐冲击性、耐磨性在0℃时基本不变。同时,本品的适温性宽,可长期在-60℃~40℃的温度下工作;
- 5、消音性:冲击能吸收性高,消音性好,从而在输送过程中减小了液体流动产生的噪音;
- 6、卫生、无毒:不霉变,不滋生细菌、卫生符合国家标准规定的指标,可接触食品和药物;
- 7、质轻、安装方便:管道比重仅为钢管重量的八分之一;柔韧性好,可直接弯曲铺设,能适应

“Senpu” polyethylene conveying slurry(PE) wear-resistant pipe is made from ultra high molecular weight polyethylene, it is an ideal pipe and has the superior performance of wear-resistant ,impact resistant, self-lubricating, corrosion resistant, good low temperature impact resistance, sanitary and non toxic, non adherence, non absorbent. The pipe can be widely used in conveying various slurry pipeline.

Features:

- 1.High wear resistance: smooth interior surface, low friction coefficient, the wear resistance is 4 times higher than steel pipe and stainless steel tube, the flow rates is 10%-40% higher than steel pipe , long term high flow-rate, and the pipe is applicable for conveying crude oil and slurry;
- 2.High shock resistance: good resistance against environmental stress cracking, high shocking resistance and absorbing shock performance;
- 3.Excellent corrosion resistance: good chemical stability, resistance to acid, alkali, salt corrosion;
- 4.Low temperature impact resistance: Good low temperature impact resistance, the wear and impact resistance can remain unchanged at 0℃.And ,the pipe has strong adaptability to ambient temperature, so that the pipe can be long term used at -60℃~40℃;
5. Acoustic performance: due to the excellent absorbing shock and acoustic performance, the pipe can reduce noise generated by liquid flow.

各种地质情况;连接安全可靠、快捷方便、无需防腐、省工省力,充分体现出使用高分子量聚乙烯管道“节能、环保、经济、高效”的优越性。

应用领域

煤炭工业:水煤浆的输送。矿山行业:尾矿及泥浆的输送,井下充填管道。

河道疏浚:清淤泥砂的输送。化工行业:腐蚀性介质的输送。

海湖盐化工:海盐输送,卤水输送。

6.Sanitary and non toxic: non mildew, non bacteria and met the national sanitation standard, the pipe can contact with food and medicine.

7.Light weight and easy installation: weight is 1/8 lighter than steel pipe; high flexibility so that can bend laying, and adapt to a variety of geological; safe and reliable connection, easy and fast installation, and the pipe can be used without preservative treatment. Those characteristics fully reflects “energy-saving, environmental protection, economy and high efficiency” of using the ultra high molecular weight polyethylene pipe. Applications:

Coal industry: CWS delivery.

Mining industry: tailings and slurry delivery, underground filling.

River dredging: mud and sand dredging.

Chemical industry: corrosive media delivery.

Sea salt lake: sea salt and brine delivery.



SENPU PIPE



滴灌带 Drip irrigation belt

“森普”牌滴灌带采用优质原料生产，是一种新型的灌溉用产品。具有重量轻，耐腐蚀，施工方便，产品抗堵塞性能好等特点。本公司可提供两大类的滴灌带产品：单翼迷宫式滴灌带；内镶贴片式滴灌带。

执行标准：

GB/T19812.1-2005《塑料节水灌溉器材 单翼迷宫式滴灌带》

GB/T19812.3-2008《塑料节水灌溉器材内镶式滴灌带、管》

产品特点：

- ★薄壁式滴灌带，迷宫流道、滴孔、管道一次成型，性能优异。
- ★较宽的迷宫水流道，水流呈紊流状态且有多个进口，具有较强的抗堵塞能力。
- ★选用优质材料，拉伸性能优良，便于机械化铺设作业。
- ★重量轻、操作搬运方便。

用途：

适用于温室、苗圃、大田、花卉以及大棚栽培作物。

“Senpu” drip irrigation belt is made from high quality raw materials, it is a new type of irrigation product, and It has the characteristics of light weight, corrosion resistant, easy installation and anti-clogging. Senpu company can provide two types of drip irrigation belt: Drip tape with labyrinth on one side; Drip pipe and tape inlaid with emitters inside.

Product Standard:GB/T19812.1-2005 "plastic equipment for water saving irrigation of single wing labyrinth dropper"

GB/T19812.3-2008 "inserting patch type drip irrigation belt in plastic water-saving irrigation equipment"

Features:

1. Thin-walled drip tape, labyrinth runner and drip hole once molding;
2. Wide labyrinth runner, turbulence flow and enough water import, so the tape has good anti-clogging ability.
3. Excellent tensile properties, to make the mechanized paving operation easier.
4. Light weight, easy installation;

Applications:

It is used in greenhouse, nursery, field, flowers and shed cultivation of crops.



滴灌管 Drip irrigation tube

“森普”牌内镶圆柱式滴灌管是新一代的节水灌溉产品，滴头一次性注塑成型，具有新型的宽长流道，自带过滤窗，宽大的过滤面积和流道断面尺寸，抗堵塞性能强。

执行标准：

GB/T19812.3-2008《塑料节水灌溉器材 内镶式滴灌管、带》

产品特点：

- ★水流呈全紊流，出水均匀度良好；
- ★自冲洗、抗堵塞性能好；
- ★机械强度高，耐腐蚀；
- ★压力损失小，灌水精度高；

用途：

适用于大田作物，大棚蔬菜及花卉、果树种植等。

产品规格：

“Senpu” drip irrigation tube is a new generation of water saving irrigation product, It has the characteristics of once injection molding ripper, new wide and long type runner, filter window, large filtration area and cross-sectional dimensions, anti-clogging.

Product Standard:

GB/T19812.3-2008 "inlaid drip irrigation pipe and belt in plastic water-saving irrigation equipment"

Features:

1. Turbulence flow and good uniformity of water;
2. Self washing, anti-clogging;
3. Excellent mechanical strength, corrosion resistant.
4. Low pressure loss, high precision irrigation;

Applications:

It is used in field, shed cultivation of crops, flowers and orchards.

公称内径, mm	8		10		12		16		20	
偏差, mm	+0.1 0				+0.2 0					
公称壁厚, mm	0.12	0.16	0.18	0.20	0.25	0.30	0.35	0.40	0.50	0.60
偏差, mm	+0.02 -0.01	+0.04 -0.01	+0.05 -0.02	+0.06 -0.03	+0.08 -0.05	+0.10 -0.06				

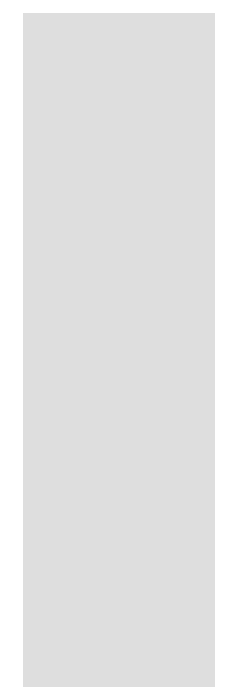



埋地式高压电力电缆用C-PVC套管 C-PVC cable sleeve

“森普”牌埋地式高压电力电缆用C-PVC套管使用优质的C-PVC原料，添加必需的加工助剂生产而成，产品达到或超过QB/T2479-2005《埋地式高压电力电缆用氯化聚氯乙烯(PVC-C)套管》标准要求，具有优良的物理力学性能。管材外观为橘红色。

执行标准：QB/T2479-2005

用途：

该产品主要用于埋设于地下，110KV以下的高压，超高压电缆或路灯电缆。

“Senpu” C-PVC cable sleeve is made from high quality raw materials and processing aids, It has the characteristics of flame retardant and anti static. the pipe reached or exceed standard QB/T2479《Buried chlorinated polyvinyl chloride (PVC-C) pipes for high-tension power cable》.The color of pipe is orange. Product Standard: QB/T2479-2005

Applications:

It is mainly used for buried high and extra-high cables that under 110KV.



执行标准 / QB/T2479-2005



公称外径 Nominal outside diameter d _n (mm)	公称壁厚 Nominal wall thickness e _n (mm)	规格 specifications d _n (mm) × e _n (mm)
110	5.0	110×5.0
139	6.0	139×6.0
167	6.0	167×6.0
	8.0	167×8.0
192	6.5	192×6.5
	8.5	192×8.5
219	7.0	219×7.0
	9.5	219×9.5

“森普”牌高寒防冻管

Anti-freeze pipe

“森普”牌高寒防冻管采用新型环保材料生产，利用“能量供给+保温”原理，可解决高寒地带上冻问题，保证24小时连续供水。

性能特点：

- 1、使用寿命长，性价比高；
- 2、卫生性好，符合GB/T17219-1998卫生安全性评价规定；
- 3、节能环保，可在较短能量供给时间内解冻上冻的水；
- 4、施工方便，无需工地现场做保温，综合造价低；
- 5、保温性能高，采用新型保温材料，比传统保温材料保温性能高。



“senpu” anti-freeze pipe is made from new environmental protection materials.with energy plus supply principle.It can ensure contious water supply for 24 hours in high cold area.

Features:

- 1.long service life, high cost performance.
- 2.It is sanitary, and reached the requirement of standard GB/T17219-1998.
- 3.Energy conservation and environmental protection.it can defrost frozen water in a short time.
- 4.Construction is convenient, and don't need the site to do insulation. The comprehensive cost is low.
- 5.The heat preservation performance is high. The new material is used in heat preservation,which is better than traditional thermal insulation material.

规格 Specifications	PPR管径(壁厚mm) PPR Nominal outside diameter and nominal wall thickness	PVC(壁厚mm) PVC Nominal outside diameter and nominal wall thickness	保温层(厚度mm) Insulating layer thickness	长度 Length
25x50	φ25*3.5	φ50*2	10.5	4m/根



管件和连接 PIPE FITTINGS AND CONNECTION

四川森普管材股份有限公司提供的配套管件有电熔管件、热熔管件（热熔对接和热熔承插）、鞍型管件、钢塑转换及球阀等五大管件系列。

本公司向客户推荐和提供各种焊接机具，并为客户培训安装人员。

执行标准：

GB/T13663.2《给水用聚乙烯（PE）管道系统第2部分：管件》

GB15558.2《燃气用埋地聚乙烯（PE）管道系统第2部分：管件》

GB/T18742.3《冷热水用聚丙烯管道系统第3部分：管件》

GB15558.3《燃气用埋地聚乙烯（PE）管道系统第3部分：阀门》

GB26255.1《燃气用聚乙烯管道系统机械管件第1部分：公称外径不大于63mm的管材用钢塑转换管件》

GB26255.2《燃气用聚乙烯管道系统机械管件第1部分：公称外径大于63mm的管材用钢塑转换管件》

Sichuan Senpu Pipe Co. Ltd offers five series fittings include electrofusion fittings, hot melt pipe fitting (butt fusion and socket welding), saddle pipe fittings, steel-plastic conversion and ball valve.

The company recommended to provide customers with all kinds of welding machine, and training for customers.

Standard:

GB/T13663.2《Polyethylene (PE) piping systems for water supply-Part2:Fittings》

GB15558.2《Buried polyethylene (PE) piping systems for the supply of gaseous fuels-Part2: Fittings》

GB/T18742.3《Polypropylene piping systems for hot and cold water installation-Part3: Fittings》

GB15558.3《Buried polyethylene (PE) piping systems for the supply of gaseous fuels-Part3: Valves》

GB26255.1《Mechanical fittings for polyethylene piping systems for the supply of gaseous-Part1: Metal fittings for pipes of nominal outside diameter less than or equal to 63mm》

GB26255.2《Mechanical fittings for polyethylene piping systems for the supply of gaseous-Part2: Metal fittings for pipes of nominal outside diameter greater than 63mm》



PE电熔管件

电熔套管/E/F Coupler



规格 specifications d	L (mm)	Z (mm)	d ₁ (mm)
S20	85	40	4.7
S25	90	43	4.7
S32	90	44	4.7
S40	95	45	4.7
S50	105	50	4.7
S63	125	60	4
S75	135	65	4.7
S90	154	74	4
S110	162	78	4
S125	165	80	4.7
S160	180	85	4.7
S180	208	100	4.7
S200	208	100	4.7
S250	215	105	4.7
S315	225	110	4.7
S335	265	130	4.7
S400	310	150	4.7

电熔等径三通/E/F Equal Tee



规格 specifications d × d × d	L (mm)	Z (mm)	Z ₁ (mm)	d ₁ (mm)
T20×20×20	100	40	40	4.7
T25×25×25	105	45	50	4.7
T32×32×32	120	45	55	4.7
T40×40×40	125	45	60	4.7
T50×50×50	145	55	60	4.7
T63×63×63	165	55	60	4.7
T75×75×75	195	68	70	4.7
T90×90×90	210	68	70	4.7
T110×110×110	240	75	79	4.7
T125×125×125	255	80	85	4.7
T160×160×160	310	90	95	4.7
T180×180×180	340	98	100	4.7
T200×200×200	360	98	105	4.7
T250×250×250	405	98	115	4.7
T315×315×315	520	125	115	4.7

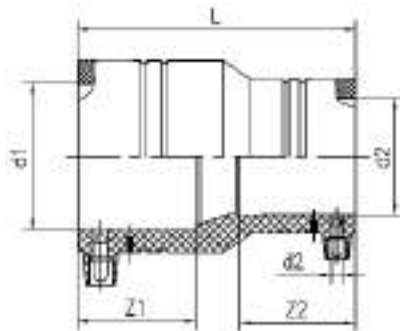

电熔异径套管/E/F Reducer

规格 specifications $d_1 \times d_2$	L (mm)	Z_1 (mm)	Z_2 (mm)	d_3 (mm)
S25×20	95	41	40	4.7
S32×20	96	44	44	4.7
S32×25	96	46	43	4.7
S40×25	106	51	45	4.7
S40×32	105	50	48	4.7
S50×25	115	54	42	4.7
S50×32	114	52	42	4.7
S50×40	115	53	42	4.7
S63×25	120	60	41	4.7
S63×32	120	61	44	4.7
S63×40	120	61	49	4.7
S63×50	120	61	52	4.7
S75×50	131	64	53	4.7
S75×63	131	65	55	4.7
S90×50	140	70	53	4.7
S90×63	140	70	60	4.7
S90×75	140	70	64	4.7
S110×63	156	78	60	4.7
S110×75	156	79	65	4.7
S110×90	156	79	67	4.7
S125×63	160	80	60	4.7
S125×90	170	80	70	4.7
S125×110	170	85	70	4.7
S160×110	197	91	77	4.7
S160×125	197	97	83	4.7
S200×160	210	95	85	4.7

森普管材 品质第一
SENPU PIPE QUALITY FIRST

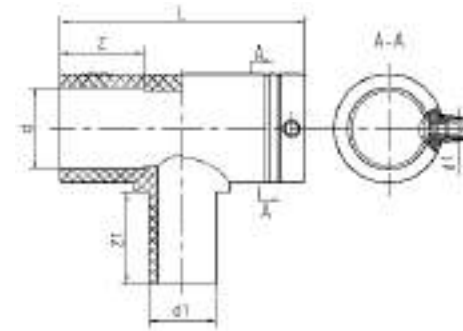

电熔异径三通/E/F Reducing Tee

规格 specifications $d \times d_1 \times d_2$	L (mm)	Z (mm)	Z_1 (mm)	d_3 (mm)
T25×20×25	101	43	38	4.7
T32×20×32	101	42	49	4.7
T32×25×32	107	43	49	4.7
T40×25×40	118	47	59	4.7
T40×32×40	125	49	58	4.7
T50×25×50	127	53	59	4.7
T50×32×50	133	53	59	4.7
T50×40×50	138	53	61	4.7
T63×25×63	130	55	61	4.7
T63×32×63	138	55	60	4.7
T63×40×63	144	56	60	4.7
T63×50×63	151	55	61	4.7
T75×32×75	195	70	70	4.7
T75×40×75	160	62	70	4.7
T75×50×75	168	60	69	4.7
T75×63×75	179	62	68	4.7
T90×32×90	158	66	81	4.7
T90×40×90	166	67	81	4.7
T90×50×90	173	66	79	4.7
T90×63×90	185	67	80	4.7
T90×75×90	195	66	80	4.7
T110×32×110	173	74	81	4.7
T110×40×110	179	74	82	4.7
T110×50×110	186	76	82	4.7
T110×63×110	198	74	80	4.7
T110×75×110	210	74	81	4.7
T110×90×110	220	74	80	4.7
T125×110×125	255	80	85	4.7
T125×63×125	260	80	85	4.7
T160×63×160	230	87	80	4.7
T160×90×160	250	88	99	4.7
T160×110×160	271	89	100	4.7
T160×125×160	285	88	100	4.7
T200×90×200	355	100	75	4.7
T200×110×200	355	100	75	4.7
T200×125×200	410	103	88	4.7
T200×140×200	410	103	93	4.7
T200×160×200	355	100	90	4.7
T250×160×250	405	100	110	4.7
T250×180×250	490	118	106	4.7
T250×200×250	405	100	110	4.7
T250×225×250	490	118	121	4.7
T315×200×315	520	125	110	4.7
T315×225×315	600	133	121	4.7
T315×250×315	520	125	110	4.7

众木成森·普被天下



电熔90°弯头/E/F Elbow

规格 specifications d	L (mm)	Z (mm)	d ₁ (mm)
L25	79	42	4.7
L32	83	44	4.7
L40	97	47	4.7
L50	113	53	4.7
L63	129	55	4.7
L75	150	64	4.7
L90	170	66	4.7
L110	200	73	4.7
L125	225	80	4.7
L160	268	89	4.7
L180	290	85	4.7
L200	320	105	4.7
L250	395	113	4.7
L315	485	129	4.7



电熔45°弯头/E/F Elbow

规格 specifications d	L (mm)	Z (mm)	d ₁ (mm)
L50	130	50	4.7
L63	160	56	4.7
L90	204	67	4.7
L110	234	73	4.7
L160	290	96	4.7
L200	330	100	4.7



电熔封堵鞍型/E/F Sealed Saddle

规格 specifications D	L (mm)	A (mm)	H (mm)	d (mm)
D90	145	154	68	4.7
D110	145	160	60	4.7
D125	145	180	65	4.7
D160	190	230	78	4.7
D200	190	235	90	4.7
D250	190	300	65	4.7
D315	190	300	75	4.7



电熔直通鞍型/E/F Straight Through Saddle

规格 specifications D × D ₁	L (mm)	A (mm)	B (mm)	H (mm)	d (mm)
D90×40	145	158	50	120	4.7
D90×50	145	158	55	125	4.7
D90×63	145	155	80	145	4.7
D110×40	145	160	50	120	4.7
D110×50	145	160	55	125	4.7
D110×63	145	160	80	145	4.7
D125×63	145	160	80	150	4.7
D160×50	235	225	55	160	4.7
D160×63	190	230	100	185	4.7
D160×90	190	230	100	185	4.7
D200×50	235	225	55	155	4.7
D200×63	190	235	110	185	4.7
D200×90	190	235	115	195	4.7
D250×50	235	300	55	165	4.7
D250×63	190	300	115	195	4.7
D250×90	190	300	115	195	4.7
D315×50	235	305	55	235	4.7
D315×63	190	300	115	195	4.7
D315×90	190	300	120	200	4.7
D315×110	235	305	125	235	4.7
D315×160	235	305	125	235	4.7



电熔旁通鞍型/E/F Tapping Saddle

规格 specifications D × D ₁	L (mm)	A (mm)	B (mm)	H (mm)	d (mm)
D63×20	110	102	45	125	4.7
D63×25	110	104	50	129	4.7
D63×32	110	104	50	129	4.7
D90×20	145	158	45	180	4.7
D90×25	140	130	75	185	4.7
D90×32	140	130	75	185	4.7
D90×63	140	130	75	185	4.7
D110×20	130	155	55	145	4.7
D110×25	130	155	55	145	4.7
D110×32	130	155	55	145	4.7
D110×63	145	160	75	175	4.7
D160×32	235	225	65	270	4.7
D160×50	235	225	120	270	4.7
D160×63	190	240	85	225	4.7
D160×90	190	240	160	225	4.7
D200×50	235	255	65	270	4.7
D200×63	190	255	85	215	4.7
D200×90	190	255	160	215	4.7
D250×50	235	300	65	270	4.7
D250×63	190	255	85	215	4.7
D250×90	190	255	160	215	4.7
D315×50	235	305	65	270	4.7
D315×63	190	310	85	240	4.7
D315×90	190	310	160	240	4.7
D315×110	235	305	82	270	4.7





PE对接管件

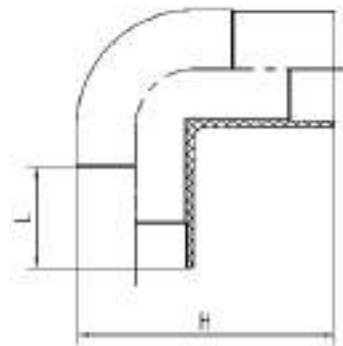

90°弯头/Elbow		
规格 specifications	L (mm)	H (mm)
L63	63	130
L75	70	160.5
L90	79	196
L110	82	203
L125	87	237.5
L140	92	241
L160	98	270
L180	105	295
L200	96	308
L225	120	367
L250	98	361
L280	139	423
L315	123	455
L355	155	550
L400	160	610
L450	155	650
L500	155	700
L630	170	850

等径三通/Equal Tee



规格 specifications	L (mm)	L ₁ (mm)	H (mm)
T63×63×63	200	65	136.5
T75×75×75	253	70	165
T90×90×90	304	79	196
T110×110×110	322	82	201
T125×125×125	330	87	227.5
T140×140×140	342	92	241
T160×160×160	380	98	265
T180×180×180	437	105	315
T200×200×200	380	78	300
T225×225×225	423	87	352
T250×250×250	517	120	400
T280×280×280	600	139	450
T315×315×315	619	137	472
T355×355×355	635	120	527
T400×400×400	675	110	580
T450×450×450	800	155	635
T500×500×500	860	140	755
T630×630×630	1000	140	885

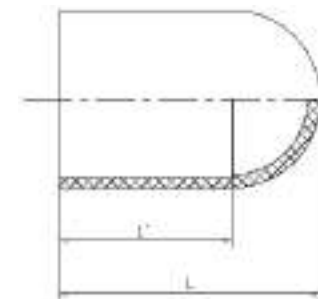

管帽/End Cap

规格 specifications	L (mm)	L ₁ (mm)
D75	110	70
D90	125	79
D110	138	82
D125	150	87
D140	166	96
D160	186	98
D180	205.5	109
D200	215	112
D225	243	120
D250	263	129
D280	284	144
D315	200	120
D355	215	155
D400	220	160
D500	240	190
D630	260	190

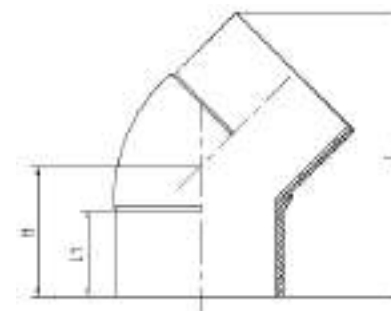

45°弯头/Elbow

规格 specifications	L (mm)	L ₁ (mm)	H (mm)
L63	160	63	80
L90	227	79	112
L110	245	82	118
L125	244	87	118
L160	302	98	145
L200	355	112	168
L250	405	130	189
L315	505	150	220
L355	530	145	235
L400	580	160	270
L450	650	155	280
L500	735	180	320
L630	820	160	360



异径套管/Reducer

规格 specifications	L (mm)	L ₁ (mm)	L ₂ (mm)
S63×25	159	63	55
S63×32	158	63	55
S63×40	157	63	57
S63×50	162	63	58
S75×32	163	70	58
S75×40	163	70	59
S75×50	163	70	57
S75×63	168	70	63
S90×32	155	80	44
S90×40	167	79	49
S90×50	158	80	55
S90×63	162	80	65
S90×75	185	80	70
S110×40	160	82	49
S110×50	175	82	55
S110×63	195	82	65
S110×75	175	82	65
S110×90	181	82	65
S125×63	196	87	63
S125×75	131	60	50
S125×90	201	87	79
S125×110	209	87	82
S140×63	220	92	63
S140×90	232	92	79
S140×110	232	92	82
S160×32	210	98	70
S160×63	252	100	63
S160×75	205	100	70
S160×90	200	100	82
S160×110	245	99.5	83.5
S160×125	224	98	87
S180×90	240	105	80
S180×110	228	105	82
S180×125	240	105	87
S180×160	240	105	98
S200×63	227	112	63
S200×90	230	112	80
S200×110	230	110	85
S200×125	230	112	87
S200×160	268	113.5	99.5
S225×110	250	110	82



异径套管/Reducer

规格 specifications	L (mm)	L ₁ (mm)	L ₂ (mm)
S225×160	258	110	100
S225×200	250	105	90
S250×110	237	110	88
S250×125	230	110	90
S250×160	245	110	100
S250×200	250	110	105
S250×225	235	110	85
S280×160	256	110	88
S280×200	250	105	90
S280×225	250	105	85
S280×250	248	110	82
S315×90	255	118	90
S315×110	255	118	92
S315×160	256	118	92
S315×180	256	118	94
S315×200	258	118	94
S315×225	255	118	95
S315×250	255	118	95
S355×200	270	100	100
S355×250	270	100	100
S355×315	240	100	100
S400×200	250	100	100
S400×250	250	100	100
S400×315	250	100	100
S400×355	250	100	100
S450×200	260	100	100
S450×250	260	100	100
S450×315	250	100	100
S450×355	250	100	100
S450×400	240	100	100
S500×315	225	80	80
S500×355	226	80	95
S500×400	250	100	100
S500×450	250	100	100
S560×355	247	100	95
S560×400	236	100	100
S560×450	199	100	80
S560×500	260	100	100
S630×400	261	100	100
S630×450	223	100	80
S630×500	260	100	100
S630×560	145	80	40



异径三通/Reducing Tee

规格 specifications	L (mm)	L ₁ (mm)	L ₂ (mm)	H (mm)
T50×25×50	170	55	41	95
T50×32×50	170	55	44	98
T50×40×50	170	55	49	105
T63×25×63	200	65	41	106.5
T63×32×63	200	65	44	111.5
T63×40×63	200	65	49	116.5
T63×50×63	200	65	55	121.5
T75×32×75	230	65	44	142.5
T75×40×75	230	65	49	147.5
T75×50×75	230	65	55	152.5
T75×63×75	230	65	65	157.5
T90×32×90	205	80	44	145
T90×40×90	215	80	49	150
T90×50×90	225	80	55	155
T90×63×90	268	67	56	163
T90×75×90	250	80	70	175
T110×32×110	220	82	44	175
T110×40×110	230	82	49	180
T110×50×110	240	82	55	185
T110×63×110	310	87	65	208
T110×75×110	265	82	70	205
T110×90×110	280	82	79	215
T125×75×125	320	85	70	212.5
T125×90×125	320	85	70	212.5
T125×110×125	320	85	80	212.5
T140×90×140	300	92	79	320
T140×110×140	320	92	82	235
T140×125×140	335	92	87	240
T160×50×160	280	100	55	230
T160×63×160	380	100	68	237
T160×75×160	380	100	72	245
T160×90×160	380	100	84	255
T160×110×160	380	95	86	260
T180×90×180	350	105	80	270
T180×110×180	370	105	82	270
T180×160×180	420	105	98	290
T200×63×200	315	112	63	260
T200×75×200	325	112	70	265
T200×90×200	340	112	79	275
T200×110×200	360	112	82	280
T200×160×200	380	75	95	300

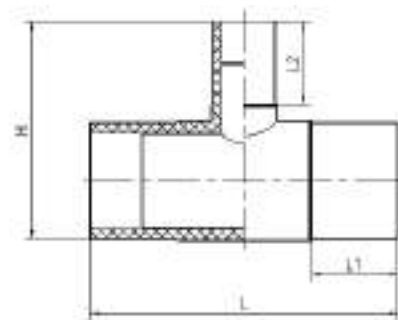

异径三通/Reducing Tee

规格 specifications	L (mm)	L ₁ (mm)	L ₂ (mm)	H (mm)
T225×90×225	360	120	79	322.5
T225×110×225	380	120	82	322.5
T225×160×225	430	120	98	327.5
T250×90×250	395	105	75	345
T250×110×250	395	105	75	345
T250×160×250	395	105	75	355
T250×200×250	395	85	75	355
T280×90×280	400	139	79	390
T280×110×280	420	139	82	395
T280×160×280	470	139	98	400
T280×200×280	510	139	112	410
T280×225×280	535	139	120	420
T280×250×280	560	139	130	430
T315×90×315	420	150	79	417.5
T315×110×315	440	150	82	417.5
T315×160×315	465	110	80	417.5
T315×200×315	465	110	80	417.5
T315×225×315	615	135	110	447.5
T315×250×315	465	95	80	417.5
T315×280×315	615	135	110	447.5
T355×250×355	620	120	120	467.5
T355×315×355	620	120	120	467.5
T400×315×400	670	130	150	580
T400×355×400	670	130	150	580

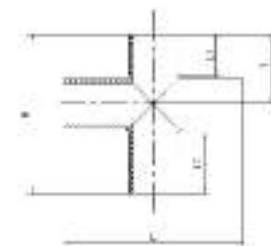

四通/Cross

规格 specifications	L (mm)	L ₁ (mm)	L ₂ (mm)	H (mm)	H ₁ (mm)
63	230	55	80	205	90
90	295	55	80	235	105
110	365	55	125	300	115
160	430	55	130	350	140
200	420	55	90	360	160
250	500	110	110	500	250
315	615	130	130	614	307
355	660	130	130	660	330



法兰头/Stub Flange

规格 specifications	SDR11				SDR17			
	L (mm)	D (mm)	D ₁ (mm)	H (mm)	L (mm)	D (mm)	D ₁ (mm)	H (mm)
63	150	102	75	14	-	-	-	-
75	150	118	82	19	-	-	-	-
90	152	135	95	22	150	138	105	15
110	155	155	115	22	150	158	125	15
125	147	180	180	20	150	158	132	22
140	150	188	155	24	150	188	155	24
160	130	205	170	23	130	205	170	23
180	160	212	180	30	160	212	180	26
200	178	265	209	37	178	265	209	37
225	167	265	231	32	167	265	231	28
250	125	320	258	37	125	320	258	37
280	193	320	291	33	193	320	291	33
315	233	370	324	35	233	370	324	30
355	236	430	370	40	236	430	370	32
400	227	480	410	42	227	480	410	42
450	208	540	460	43	208	540	460	43
500	180	585	530	50	175	585	515	44
560	185	685	615	56	193	675	569	51
630	185	685	642	56	177	685	640	51
710	-	-	-	-	185	800	737	56
800	-	-	-	-	185	905	840	56
900	-	-	-	-	185	1005	944	56
1000	-	-	-	-	185	1100	1047	56

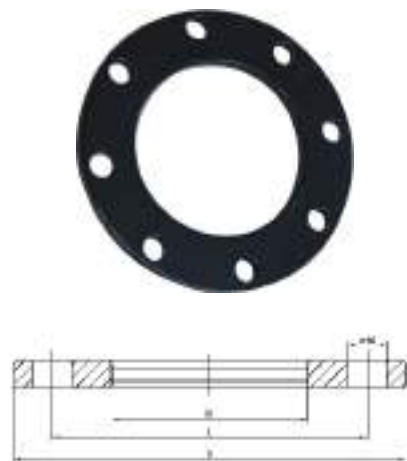

钢法兰片/Steel Flange Plate

规格 specifications	PE管外径 pipe outside diameter	D ₁ (mm)	PN1.0MPa			PN1.6MPa		
			D (mm)	L (mm)	n-d (mm)	D (mm)	L (mm)	n-d (mm)
32	32	43	135	100	4-18	-	-	-
40	40	54	138	110	4-18	145	110	4-18
50	50	64	154	125	4-18	160	125	4-18
50	63	72	154	125	4-18	160	125	4-18
65	75	90	176	145	4-18	180	145	4-18
80	90	102	188	160	8-18	195	160	8-18
100	110	122	208	180	8-18	215	180	8-18
125	125	138	238	210	8-18	245	210	8-18
125	140	156	238	210	8-18	245	210	8-18
150	160	172	272	240	8-22	280	240	8-22
150	180	192	272	240	8-22	280	240	8-22
200	200	215	328	295	8-22	335	295	12-22



钢法兰片/Steel Flange Plate

规格 specifications	PE管外径 pipe outside diameter	D ₁ (mm)	PN1.0MPa			PN1.6MPa		
			D (mm)	L (mm)	n-d (mm)	D (mm)	L (mm)	n-d (mm)
200	225	238	328	295	8-22	335	295	12-22
250	250	272	384	350	12-22	405	355	12-25
250	280	296	384	350	12-22	405	355	12-25
300	315	333	434	400	12-22	460	410	12-25
350	355	373	494	460	16-22	520	470	16-25
400	400	428	554	515	16-25	580	525	16-30
450	450	480	604	565	20-25	640	585	20-30
500	500	530	658	620	20-25	705	650	20-33
500	560	586	658	620	20-25	705	650	20-33
600	630	656	768	725	20-30	840	770	20-40
700	710	738	895	840	24-30	910	840	20-40
800	800	842	1010	950	24-33	1020	950	20-40
900	900	947	1110	1050	28-33	1120	1050	28-40
1000	1000	1050	1220	1160	28-36	1255	1170	28-46
1200	1200	1253	1450	1380	32-39	1485	1390	32-52

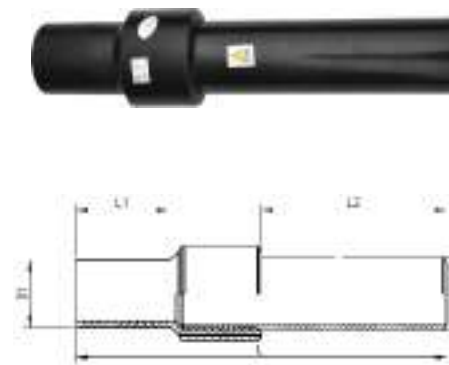

钢塑过渡 PE/Steel Transition

规格 specifications	PE ΦD ₁ (mm)	钢管 ΦD ₂ (mm)	L (mm)	L ₁ (mm)	L ₂ (mm)
DN25	25	27	394	73	274
DN32	32	27	405	105	225
DN32	32	34	418	92	274
DN40	40	34	405	110	225
DN40	40	42	400	81	265
DN50	50	48	419	90	265
DN63	63	48	410	115	225
DN63	63	57	424	127	232
DN63	63	60	375	80	230
DN75	75	76	550	100	355
DN90	90	76	535	100	355
DN90	90	89	505	102	308
DN110	110	89	550	125	355
DN110	110	108	531	103	320
DN160	160	159	575	160	325
DN200	200	203	600	165	345
DN200	200	219	600	150	345
DN250	250	245	650	180	360
DN250	250	273	680	200	370
DN315	315	299	680	205	370
DN315	315	325	680	245	425



PE承插管件

管帽/End Cap

规格 Specifications	L (mm)	L ₁ (mm)
D20	21.5	15
D25	24.5	16
D32	28	18.1
D40	33	25
D50	39	29.5
D63	45	27.4

套管/Coupler

规格 Specifications	L (mm)	L ₁ (mm)
S20	34	15.5
S25	37	17
S32	42	19.1
S40	48	22
S50	54	24.5
S63	63	28.9
S75	73	32

异径套管/Reducer

规格 Specifications	L (mm)	L ₁ (mm)	L ₂ (mm)
S25×20	38	16	14.5
S32×20	41	18.1	14.5
S32×25	40	18.1	16
S40×20	47.5	20.5	14.5
S40×25	46.5	20.5	16
S40×32	46.5	20.5	18.1
S50×20	59	23.5	14.5
S50×25	53	23.5	16
S50×32	52	23.5	18.1
S50×40	52	23.5	20.5
S63×20	64	27.4	14.5
S63×25	63	27.4	16
S63×32	62	27.4	18.1
S63×40	60	27.4	20.5
S63×50	58.5	27.4	23.5
S75×32	78	31	18.1
S75×40	76.5	31	20.5
S75×50	75	31	23.5
S75×63	74	31	27.4



等径三通/Equal Tee

规格 Specifications	L (mm)	L ₁ (mm)
T20×20×20	57	15.5
T25×25×25	65	17
T32×32×32	76	19.1
T40×40×40	89	22
T50×50×50	105	24.5
T63×63×63	126	28.9

异径三通/Reducing Tee

规格 Specifications	L (mm)	L ₁ (mm)	L ₂ (mm)	H (mm)	H ₁ (mm)
T25×20	64	16	14.5	44	27
T32×20	66	18.1	14.5	54	33
T32×25	70	18.1	16	57	36
T40×20	71	20.5	14.5	64	37.5
T40×25	74	20.5	16	64.5	38
T40×32	78	20.5	18.1	66	39.5
T50×20	71	23.5	14.5	76	43
T50×25	81	23.5	16	76.5	43.5
T50×32	86	23.5	18.1	80.5	47.5
T50×40	93	23.5	20.5	83.5	50.5
T63×20	82	27.4	14.5	90	49
T63×25	88	27.4	16	93	52
T63×32	94	27.4	18.1	95	54
T63×40	101	27.4	20.5	96.5	55.5
T63×50	110	27.4	23.5	97	56
T75×40	108	31	20.5	109.5	61
T75×50	120	31	23.5	110	61.5
T75×63	130	31	27.4	111.5	63

森普管材 品质第一
SENPU PIPE QUALITY FIRST



90°弯头/Elbow



规格 Specifications	L (mm)	L _i (mm)
L20	28.5	19.5
L25	32.5	17
L32	38	19.1
L40	44.5	22
L50	52.5	24.5
L63	63	28.9

45°弯头/Elbow



规格 Specifications	L (mm)	L _i (mm)
L20	46.8	14.5
L25	52.4	16
L32	63.1	18.1
L40	75.5	20.5
L50	90.2	23.5
L63	108.3	27.4
L75	124.9	30

内螺纹弯头/Female Threaded Elbow



规格specifications
L20 × 1/2" F
L25 × 1/2" F
L25 × 3/4" F
L32 × 1" F

外螺纹弯头/Male Threaded Elbow

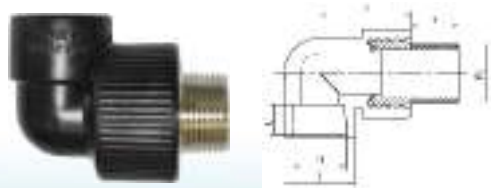

规格specifications
L20 × 1/2" M
L25 × 1/2" M
L25 × 3/4" M
L32 × 1" M



内螺纹三通/Female Threaded Tee



规格specifications

- T20 × 1/2" F
- T25 × 1/2" F
- T25 × 3/4" F
- T32 × 1" F
- T32 × 1/2" F
- T32 × 3/4" F

外螺纹三通/Male Threaded Tee

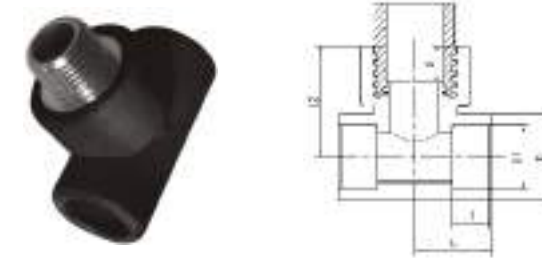

规格specifications

- T20 × 1/2" M
- T25 × 1/2" M
- T25 × 3/4" M
- T32 × 1" M
- T32 × 1/2" M
- T32 × 3/4" M

外螺纹直接/Male Threaded Adapter

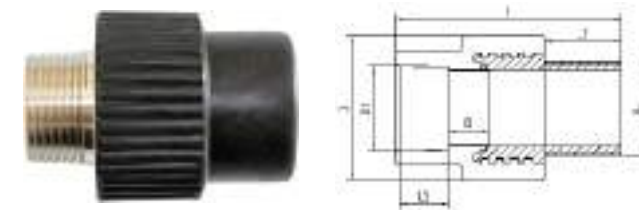

规格 specifications

- S20 × 1/2" M
- S25 × 1/2" M
- S25 × 3/4" M
- S32 × 1" M
- S32 × 1/2" M
- S32 × 3/4" M
- S40 × 1 1/4" M
- S50 × 1 1/2" M
- S63 × 2" M

森普管材 品质第一
SENPU PIPE QUALITY FIRST



内螺纹直接/Female Threaded Adapter

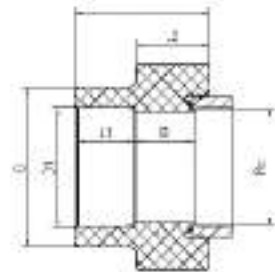

规格 specifications

- S20 × 1/2''F
- S25 × 1/2''F
- S25 × 3/4''F
- S32 × 1''F
- S40 × 1 1/4''F
- S50 × 1 1/2''F
- S63 × 2''F

标准型PE球阀/PE Ball Valve

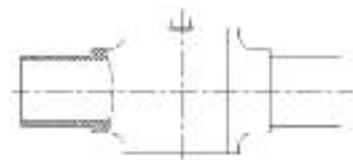

规格 specifications

- Φ32
- Φ40
- Φ50
- Φ63
- Φ75
- Φ90
- Φ110
- Φ125
- Φ160
- Φ200
- Φ250
- Φ315

PE球阀/ PE Ball Valve

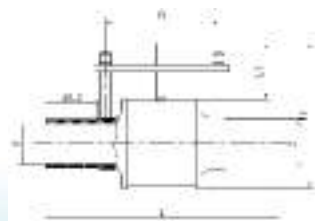

规格 Nominal size D	L (mm)	L ₁ (mm)	L ₂ (mm)	H (mm)	B (mm)	d (mm)
90	720	740	160	980	350	70
110	720	740	160	980	350	87
160	780	740	140	1080	420	126
200	780	740	140	1080	420	159
250	960	740	160	1220	600	195
315	960	740	160	1220	600	255

PE焊制管件

11.25° 弯头/Elbow

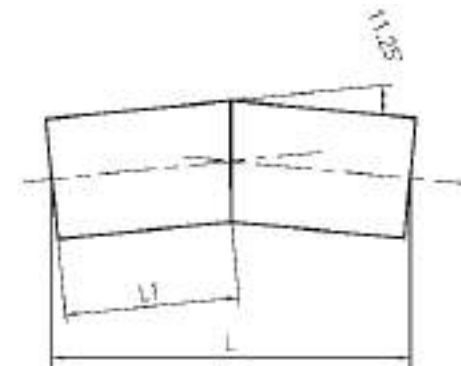

规格 specifications	L (mm)	L ₁ (mm)
L90	188	90
L110	190	90
L125	211	100
L140	213	100
L160	254	120
L180	256	120
L200	278	130
L225	301	140
L250	303	140
L280	346	160
L315	349	160
L355	363	165
L400	407	185
L450	432	195
L500	517	235
L560	542	245
L630	575	255

22.5° 弯头/Elbow

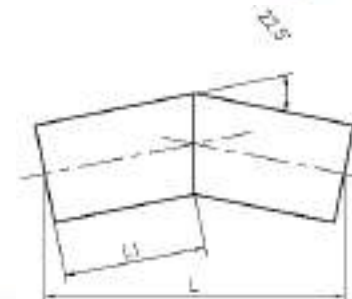

规格 specifications	L (mm)	L ₁ (mm)
L90	194	90
L110	198	90
L125	221	100
L140	224	100
L160	267	120
L180	271	120
L200	294	130
L225	319	140
L250	323	140
L280	369	160
L315	375	160
L355	393	165
L400	441	185
L450	470	195
L500	559	235
L560	590	245
L630	623	255



45° 弯头/Elbow



规格 specifications	L (mm)	L ₁ (mm)	L ₂ (mm)
L90	275	90	85
L110	282	90	85
L125	315	100	95
L140	320	100	95
L160	383	120	115
L180	386	120	115
L200	424	130	125
L225	461	140	135
L250	469	140	135
L280	535	160	155
L315	548	160	155
L355	566	165	150
L400	637	185	170
L450	682	195	180
L500	793	235	220
L560	850	245	220
L630	874	255	220

90° 弯头/Elbow

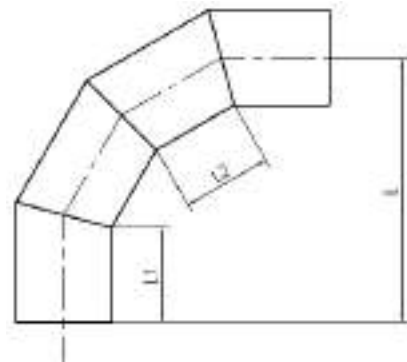

规格 specifications	L (mm)	L ₁ (mm)	L ₂ (mm)
90	251	90	85
110	261	90	85
125	292	100	95
140	330	100	95
160	357	120	115
180	367	120	115
200	401	130	125
225	437	140	135
250	449	140	135
280	456	160	155
315	529	160	155
355	547	165	150
400	617	185	170
450	666	195	180
500	786	235	220
560	826	245	220
630	871	255	220

正三通/Equal Tee

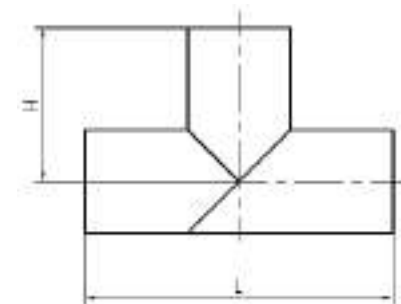

规格 specifications	L (mm)	H (mm)
90	270	135
110	290	145
125	325	162.5
140	340	170
160	400	200
180	420	210
200	460	230
225	505	252.5
250	530	265
280	600	300
315	635	317.5
355	685	342.5
400	770	385
450	840	420
500	970	485
560	1050	525
630	1140	570

正四通/Cross

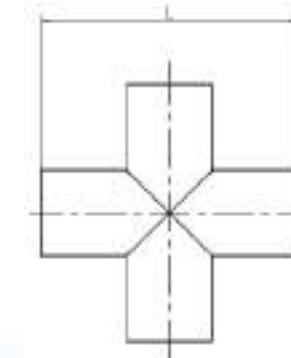
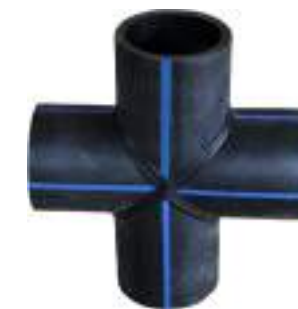

规格 specifications	L (mm)
140	420
160	440
180	480
200	500
225	545
250	570
280	640
315	675
355	825
400	876
450	920
500	1090
560	1170
630	1240



异径鞍型三通/Reducing Tee Saddle

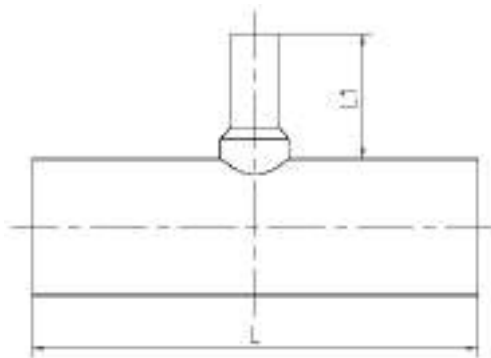

规格 specifications	L (mm)	L ₁ (mm)
T125X32	700	200
T125X40	700	200
T125X50	700	200
T140X32	700	200
T140X40	700	200
T140X50	700	200
T140X63	700	200
T160X32	700	200
T160X40	700	200
T180X32	700	200
T180X40	700	200
T180X50	700	200
T180X63	700	200
T200X32	700	200
T200X40	700	200
T200X50	700	200
T200X63	700	200
T200X75	700	200
T200X90	700	200
T225X32	700	200
T225X40	700	200
T225X50	700	200
T225X63	700	200
T225X90	700	200
T250X63	700	200
T250X90	700	200
T250X110	700	200

众木成森, 普被天下.

SENPU PIPE
PRODUCT MANUAL



异径三通/Reducing Tee

规格 specifications	L (mm)	L ₁ (mm)
T280X63	700	200
T280X75	700	200
T280X90	700	200
T280X110	700	200
T315X63	700	200
T315X75	700	200
T315X90	700	200
T315X110	700	200
T355X63	700	200
T355X75	700	200
T355X90	700	200
T355X110	700	200
T355X160	700	200
T400X63	700	200
T400X75	700	200
T400X90	700	200
T400X110	700	200
T400X160	700	200
T450X63	700	200

规格 specifications	L (mm)	L ₁ (mm)
T450X75	700	200
T450X90	700	200
T450X110	700	200
T450X160	700	200
T500X63	700	200
T500X75	700	200
T500X90	700	200
T500X110	700	200
T500X160	700	200
T560X63	700	200
T560X75	700	200
T560X90	700	200
T560X110	700	200
T560X160	700	200
T630X63	700	200
T630X75	700	200
T630X90	700	200
T630X110	700	200
T630X160	700	200

Y型三通 / Y Tee

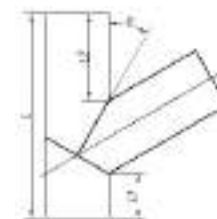

规格 specifications	L ₁ (mm)	L ₂ (mm)	L(mm)	
			θ = 45°	θ = 60°
225	180	500	999	940
250	200	500	1054	989
280	220	500	1116	1043
315	240	500	1186	1104
355	240	500	1242	1150
400	270	500	1336	1232
450	300	500	1437	1627
500	320	650	1678	1548
560	350	650	1792	1647
630	400	650	1941	1777



PP-R管件

PP-R异径三通/Reducing Tee



规格 specifications	L (mm)	L ₁ (mm)	L ₂ (mm)	H (mm)	H ₁ (mm)
T25 × 20	64	16	14.5	44	27
T32 × 20	66	18.1	14.5	54	33
T32 × 25	70	18.1	16	57	36
T40 × 20	71	20.5	14.5	64	37.5
T40 × 25	74	20.5	16	64.5	38
T40 × 32	78	20.5	18.1	66	39.5
T50 × 20	71	23.5	14.5	76	43
T50 × 25	81	23.5	16	76.5	43.5
T50 × 32	86	23.5	18.1	80.5	47.5
T50 × 40	93	23.5	20.5	83.5	50.5
T63 × 20	82	27.4	14.5	90	49
T63 × 25	88	27.4	16	93	52
T63 × 32	94	27.4	18.1	95	54
T63 × 40	101	27.4	20.5	96.5	55.5
T63 × 50	110	27.4	23.5	97	56
T75 × 40	108	31	20.5	109.5	61
T75 × 50	120	31	23.5	110	61.5
T75 × 63	130	31	27.4	111.5	63
T90 × 50	126	35.5	23.5	125	67.5
T90 × 63	139	35.5	27.4	126	68.5
T90 × 75	151	35.5	31	128	70.5
T110 × 63	152	41.5	27.4	151	82
T110 × 75	164	41.5	31	152.5	83.5
T110 × 90	179	41.5	35.5	153	84

钢法兰片/Steel Flange Plate



规格 specifications		D (mm)	D ₁ (mm)	L (mm)	n-d (mm)
PP-R管外径	阀门公称直径				
32	32	135	43	100	4-18
40	40	145	55	110	4-19
50	50	165	68	125	4-20
63	50	165	85	125	4-21
75	65	185	101	145	4-22
90	80	200	124	160	8-18
110	100	220	150	180	8-18



PP-R异径套管/Reducer

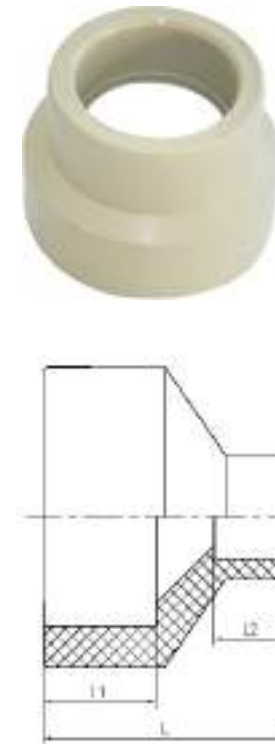

规格 specifications	L (mm)	L ₁ (mm)	L ₂ (mm)
S25 × 20	38	16	14.5
S32 × 20	41	18.1	14.5
S32 × 25	40	18.1	16
S40 × 20	47.5	20.5	14.5
S40 × 25	46.5	20.5	16
S40 × 32	46.5	20.5	18.1
S50 × 20	59	23.5	14.5
S50 × 25	53	23.5	16
S50 × 32	52	23.5	18.1
S50 × 40	52	23.5	20.5
S63 × 20	64	27.4	14.5
S63 × 25	63	27.4	16
S63 × 32	62	27.4	18.1
S63 × 40	60	27.4	20.5
S63 × 50	58.5	27.4	23.5
S75 × 40	76.5	31	20.5
S75 × 50	75	31	23.5
S75 × 63	74	31	27.4
S90 × 50	76	35.5	23.5
S90 × 63	75	35.5	27.4
S90 × 75	72.4	35.5	31
S110 × 63	93	41.5	27.4
S110 × 75	92	41.5	31
S110 × 90	89	42.5	33.5

PP-R 90° 弯头/Elbow



规格 specifications	L (mm)	L ₁ (mm)
L20	29	14.5
L25	34	16
L32	37	18.1
L40	45	20.5
L50	52	23.5
L63	64	27.4
L75	69	31.5
L90	80.5	35.5
L110	97.5	42.5



PP-R 45° 弯头/Elbow

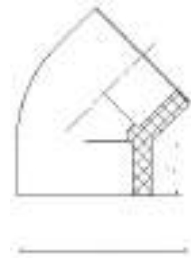

规格 specifications	L (mm)	L ₁ (mm)
L20	46.8	14.5
L25	52.4	16
L32	63.1	18.1
L40	75.5	20.5
L50	90.2	23.5
L63	108.3	27.4
L75	124.9	30

PP-R 等径三通/Equal Tee

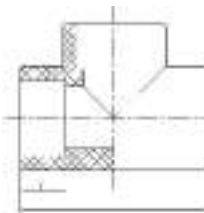

规格 specifications	L (mm)	L ₁ (mm)
T20 × 20 × 20	56	14.5
T25 × 25 × 25	64	16
T32 × 32 × 32	76	18.1
T40 × 40 × 40	88	20.5
T50 × 50 × 50	104	23.5
T63 × 63 × 63	126	27.4
T75 × 75 × 75	158	31.5
T90 × 90 × 90	168	35.5
T110 × 110 × 110	200	42.5

PP-R 管帽/End Cap

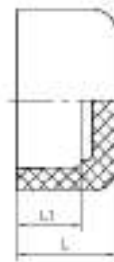

规格 specifications	L (mm)	L ₁ (mm)
D20	21.5	14.5
D25	24.5	16
D32	28	18.1
D40	33	20.5
D50	39	23.5
D63	45	27.4

PP-R 内螺纹三通/PP-R Female Threaded Tee

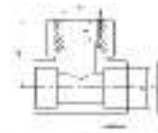

规格 specifications

T20 × 1/2" F

T25 × 1/2" F

T25 × 3/4" F



PP-R 绕曲管/PP-R Crooked Pipe

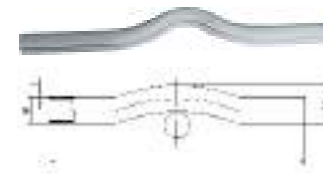

规格 specifications	E				H (mm)	L (mm)
	S5	S4	S3.2	S2.5		
d _n 20	2.0	2.3	2.8	3.4	56	365
d _n 25	2.3	2.8	3.5	4.2	67	365
d _n 32	2.9	3.6	4.4	5.4	77	370

PP-R 法兰头/Stub Flange

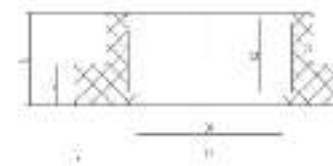

规格 specifications	D (mm)	D ₁ (mm)	L (mm)	L ₁ (mm)	L ₂ (mm)
F63	102	55	33	15	29.5
F75	121	62.5	38.5	15.5	34.5
F90	141	80	42.5	18	37.5
F110	160	100	51	21	42

PP-R 套管/Coupler



规格 specifications	L (mm)	L ₁ (mm)
S20	36.5	14.5
S25	38.5	16
S32	43	18.1
S40	49	20.5
S50	55	23.5
S63	63	27.4
S75	73.5	32
S90	80	35.5
S110	90	42.5



PP-R 外螺纹直套管/PP-R Male Threaded Adapter

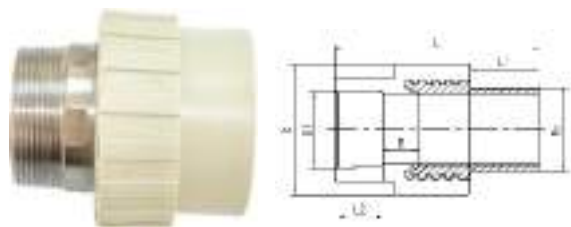

规格 specifications

- S20 × 1/2" M
- S25 × 1/2" M
- S25 × 3/4" M
- S32 × 1" M
- S40 × 1 1/4" M
- S50 × 1 1/2" M
- S63 × 2" M

PP-R 内螺纹直套管/PP-R Female Threaded Adapter



规格 specifications

- S20 × 1/2" F
- S25 × 1/2" F
- S25 × 3/4" F
- S32 × 1" F
- S40 × 1 1/4" F
- S63 × 2" F

PP-R 内螺纹弯头/PP-R Female Threaded Elbow



规格 specifications

- L20 × 1/2" F
- L25 × 1/2" F
- L25 × 3/4" F
- L32 × 1" F

PP-R 外螺纹弯头/PP-R Male Threaded Elbow



规格 specifications

- L20 × 1/2" M
- L25 × 1/2" M
- L25 × 3/4" M
- L32 × 1" M
- L32 × 1/2" M
- L32 × 3/4" M



PP-R 外螺纹三通/Male Threaded Tee

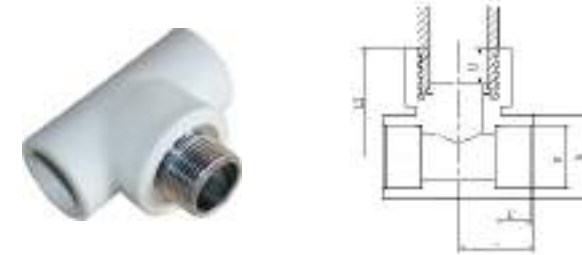

规格 specifications

- T20 × 1/2" M
- T25 × 1/2" M
- T25 × 3/4" M
- T32 × 1" M
- T32 × 1/2" M
- T32 × 3/4" M

PP-R 截止阀/ Stop Valve

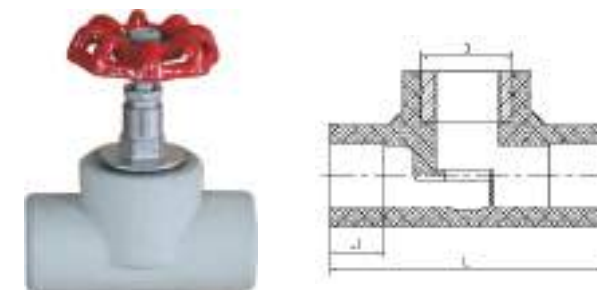

规格 specifications

- 20
- 25
- 32
- 40
- 50
- 63
- 75

活接/Union

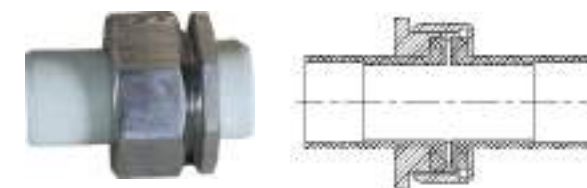

规格 specifications

- 20
- 25
- 32
- 40
- 50
- 63